

Ceiling Mounted Data Projector

Ceiling Mount

Minimum: Threaded post
 Preferred: Movable track-rail for future repositioning:
 Use 4 unistrut rails, 2 set perpendicular, 6' long and spaced 3' apart and 2 set parallel to the screen, 4' long for mounting the pipe hanger support to the projector. (Image from Penn State 3/6/09)
 Lift: Required in tiered rooms over 60 capacity, or per data sheets
 Cage: Typically Required. See room data sheets

Conduit / power

Power in ceiling (standard AC receptacle outlet)
 Conduit to AV control area

Mounting distance from screen

Model to be specified per project
 Throw distance can be determined by:
<http://www.projectorcentral.com/Sharp-XG-C435X-projection-calculator-pro.htm>
 Choose appropriate projector model
 Use 4:3 projection ratio and pre-established image size (not screen size)

Typical throw distances (NOT FOR CONSTRUCTION)

Image Size	Throw Distance	Range
4 x 7	13'5	+ - 1'
6 x 8	15'4	+ - 1'
7'6 x 10	19'2	+ - 1'
9 x 12	23'	+ - 1'

Rule of thumb:
 throw = 2x image width

Location Notes

- Projector location to be shown in correct position on ceiling plan to show that location not in conflict with lighting grid and HVAC vents
- Throw area to be clear ceiling without interference of hung lighting fixtures
- Projection mount + - 6" below clear ceiling

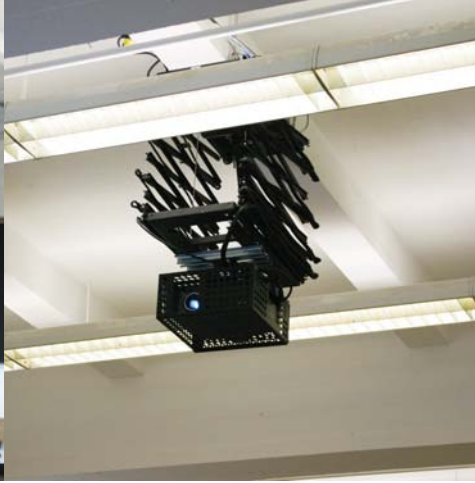

longitudinal section

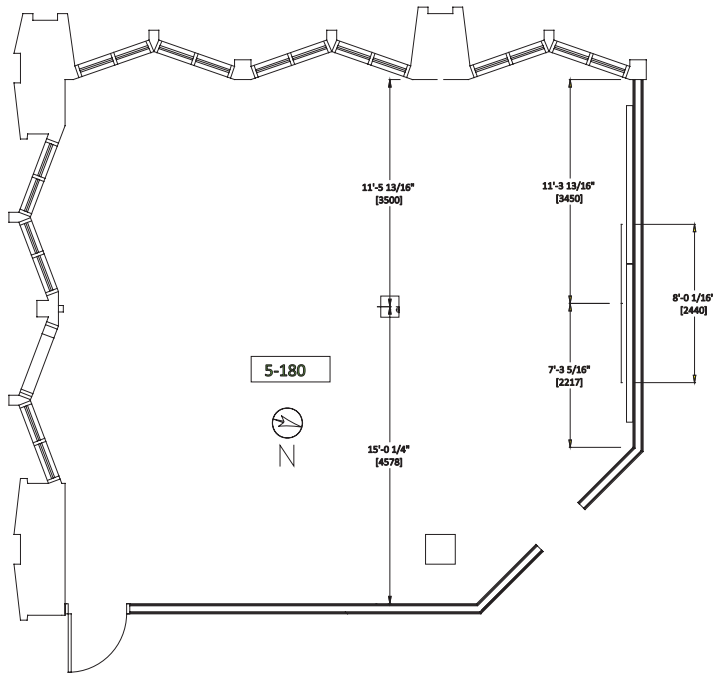
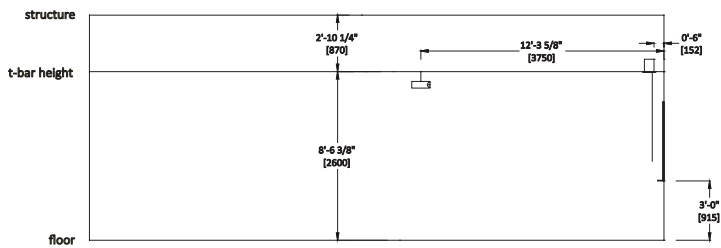

presentation wall

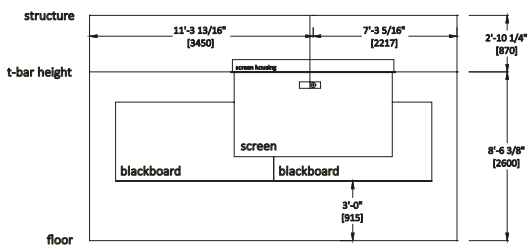

SAMPLE NOT FOR CONSTRUCTION